

UL approved Single Phase transformer series WST2UL

The transformers in the WST2UL series are specially approved for the North American market and meet national and international requirements for worldwide use. Designed according to the following specifications:

- **Voltages selectable** by customer prior to order
 - Primary nominal voltage range 110V-600V incl. any number of taps possible (e.g. +/-10% over voltage taps)
 - Maximum 4 separate secondary windings incl. any number of taps possible (sum max. 660V when using over voltage taps)
 - Open frame, stationary, for device installation and assembly in dry rooms, separate windings.
 - From 50A with terminal blocks on top bracket
 - High reliability and long life
 - Low overall losses, high efficiency
 - Above-averagely high power for short-time operation
 - Upon request by the customer for secondary voltage to 50VAC (V no-load) non-isolated cable connection (optional)
 - Optional: PE screw terminal connector and PE shield
- Autotransformer** * adapted to type power

*) Suffix -A = Autotransformer

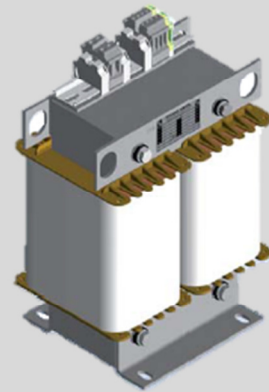

Specifications

Power:	500VA – 25kVA
Frequency:	50 – 60 Hz
Primary:	100V - 600V
Secondary:	10V – 600V (0.5-3kVA), 19V – 600V (8 – 13kVA) or 80V – 600V (16 – 25kVA)
Temp. class:	ta40°C/B
Protection:	IP00
According to:	EN 61558
Approval:	UL5085 / CSA 22.2



Dimensions and fittings:

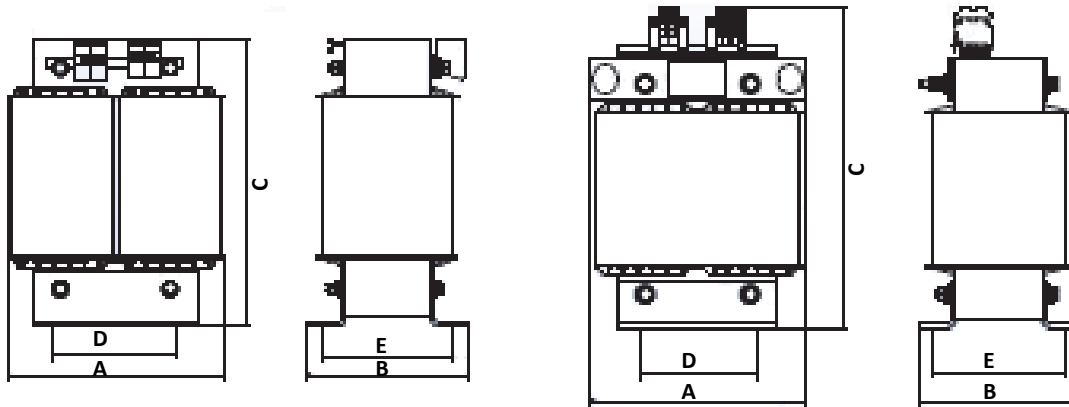

Technical Specification									
Power [VA]	Size	Copper [kg]	Total [kg]	Dimensions approx. in mm					Mounting
				A	B	C	D	E	
500	UI 90/41	1.50	5.2	120	85	157	66	76	M6
630	UI 90/51	1.80	6.3	120	95	157	76	76	M6
800	UI 114/40	2.20	7.7	154	90	198	100	95	M6
100	UI 102/57	2.75	7.9	140	103	177	76	87	M6
1200	UI 120/51	4.85	13.6	160	105	208	100	79	M6
1400	UI 114/64	3.85	13.0	154	114	198	100	95	M6
1500	UI 120/61	4.95	15.0	160	115	208	100	95	M6
1800	UI 120/75	6.05	17.0	160	129	208	100	103	M6
2000	UI 132/72	6.45	20.0	178	132	223	112	102	M3
2200	UI 150/52	7.25	21.0	200	122	260	124	94	M8
2500	UI 150/65	7.90	24.8	200	135	260	124	107	M8
3000	UI 150/77	8.35	28.0	200	147	260	124	107	M8
4200	UI 150/92	10.10	31.0	200	162	260	124	134	M8
5000	UI 150/103	14.20	38.5	200	173	260	124	145	M8
6000	UI 168/92	16.50	42.0	228	172	287	136	144	M8
6300	UI 180/78	18.50	48.0	240	168	305	144	140	M8
8000	UI 180/93	22.75	57.0	240	183	305	144	155	M8
10000	UI 210/88	32.00	78.0	280	188	360	176	158	M10
13000	UI 210/103	36.30	89.0	280	203	360	176	173	M10
16000	UI 210/133	46.10	112.0	280	233	360	176	203	M10
20000	UI 240/140	46.20	129.0	320	250	410	196	214	M14
25000	UI 240/140	49.05	136.0	320	250	410	196	214	M14